

PLAKA – CEMFLEX VB et CEMFLEX NB NG
Active sealing sheet for resumption of concreting and shrinkage joint
REF 05.06.08 - Version V04 – 04/11/2021

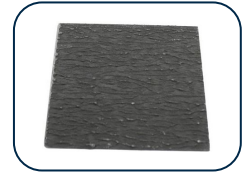

Description



CEMFLEX VB and CEMFLEX VB NG sealing sheets are 0.75 mm thick galvanized steel sheets covered on both sides with a special patented coating of approximately 0.25 mm thick.

The CEMFLEX VB sheet is flat, the CEMFLEX VB NG sheet has a 30mm bend. It will be fixed using VGATESL15 brackets.

In addition to the very good bond between the coating of the sheet and the surrounding concrete, the special active coating of this sheet causes crystallization and calcification which will form in the capillary system and in the microcracks of the concrete, preventing the passage of water to the right of the return joint.

The sheet metal coating does not stick. A sheet metal protection film which should be removed before concreting is therefore not necessary.

The application of CEMFLEX VB sheet is covered by ETA -16-0601 and DTA CSTB 3.3 / 19-1006_V1



Applications

CEMFLEX VB and CEMFLEX VB NG waterproofing sheets can be used in all construction joints, horizontal or vertical.

CEMFLEX VB NG sheets take up hydrostatic pressure up to 2 bar (20 m of water column) with an overlap of 20cm. For an overlap of 5cm, the admissible pressure is 0.8 bar.

They apply:

- for waterproofing all horizontal and vertical construction joints
- for all recovery joints to be made watertight in foundation work, and in basements, civil engineering work such as tunnels, underground constructions or other personalized solutions.

Specifications

- Galvanized steel sheet 0.75 mm thick, covered on both sides with a mineral coating \pm 0.25 mm thick, formed of particles of cement and calcium hydroxide.

CEMFLEX VB will adhere to the concrete by chemical reaction and make the joint permanently waterproof.

- The active sealing process is triggered by the reaction of the different components of the special coating when they come into contact with the constituents of the concrete.



©Protégé par le droit d'auteur

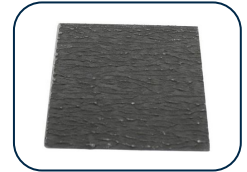

Cette fiche, élaborée avec le plus grand soin, annule et remplace toutes les versions précédentes. Les informations techniques sur la conception, les modèles, les illustrations, les valeurs de calcul et les spécifications sont communiquées à titre indicatif et sans engagement. Nous n'assumons aucune responsabilité en cas d'application erronée ou non adaptée. Nous nous réservons le droit de modifier le contenu de cette fiche sans avis préalable.

PLAKA – CEMFLEX VB et CEMFLEX NB NG
 Active sealing sheet for resumption of concreting and
 shrinkage joint

REF 05.06.08 - Version V04 – 04/11/2021

Dimensions

Dimensions des matériaux					
Schéma	Code	Description	Length/ width (mm/mm)	p/Box	Weight (Kg/m)
	RS4433	Waterproofing sheet CEMFLEX VB Height : 150 mm	2000 / ±1,25	100ml	1,00
	RS443350M	Waterproofing sheet CEMFLEX VB Height : 150 mm		50ml	
	RS4434	Waterproofing sheet CEMFLEX VB Height : 100 mm	2000 / ±1,25	100ml	0,67
	RS4449	Waterproofing sheet CEMFLEX VB NG Height : 120 mm Base width : 30 mm	2000 / ±1,25	100ml	1,00

Accessoires					
Schéma	Référence	Description	Height (mm)	p/Box	Weight (Kg/1)
	RS4436	Reinforcement clips (min 2 pieces to be provided per sheet)	-	50	0,0053
	VGATES20	Spiral support for installation of CEMFLEX VB	120	1	0,48
	VGATESL15	Pin support for installation of CEMFLEX VB NG and CEMFLEX VB	100	1	0.04

©Protégé par le droit d'auteur

Cette fiche, élaborée avec le plus grand soin, annule et remplace toutes les versions précédentes. Les informations techniques sur la conception, les modèles, les illustrations, les valeurs de calcul et les spécifications sont communiquées à titre indicatif et sans engagement. Nous n'assumons aucune responsabilité en cas d'application erronée ou non adaptée. Nous nous réservons le droit de modifier le contenu de cette fiche sans avis préalable.

PLAKA – CEMFLEX VB et CEMFLEX NB NG
Active sealing sheet for resumption of concreting and
shrinkage joint

REF 05.06.08 - Version V04 – 04/11/2021

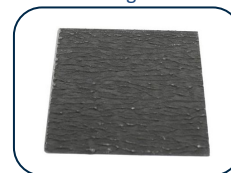

Mise en œuvre

- Place the CEMFLEX VB sealing sheet in the middle of the joint, between the pending reinforcements.
- Using the spiral brackets, place the CEMFLEX VB sheet on the upper reinforcement of the slab / foundation. The brackets must be provided with a center distance of approximately 500 mm
Note: CEMFLEX VB waterproofing sheet can also be easily inserted into fresh concrete

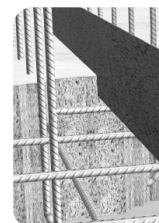

- Provide an overlap between two sheets of at least 50 mm.
- For CEMFLEX VB sheet, the cover must be fixed in the upper part and in the lower part by CEMFLEX VB reinforcement clips. In the case of the folded sheet CEMFLEX VB NG, since the base of the sheet is ligated, only one reinforcing clip will be necessary in the upper part of the junction of the two sheets.

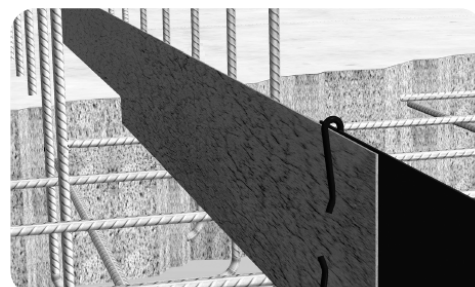
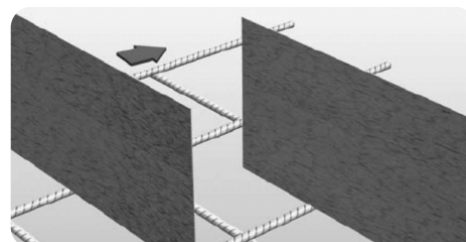

- The shape of the CEMFLEX VB sheet can be easily changed and can thus adapt to corners or curves



©Protégé par le droit d'auteur

Cette fiche, élaborée avec le plus grand soin, annule et remplace toutes les versions précédentes. Les informations techniques sur la conception, les modèles, les illustrations, les valeurs de calcul et les spécifications sont communiquées à titre indicatif et sans engagement. Nous n'assumons aucune responsabilité en cas d'application erronée ou non adaptée. Nous nous réservons le droit de modifier le contenu de cette fiche sans avis préalable.